

rasomuro 55s_

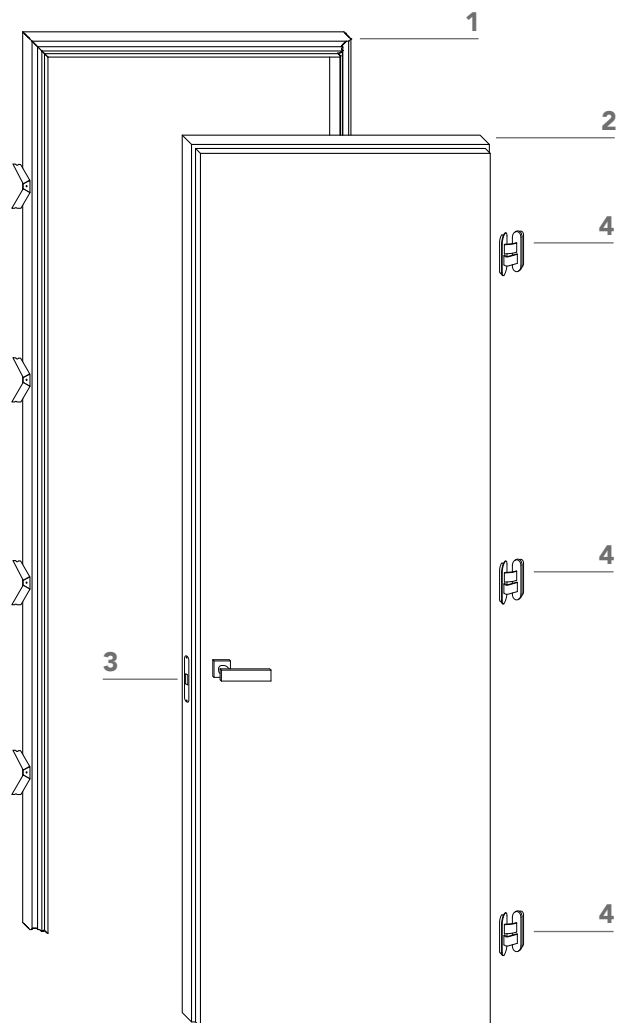

1 telaio in alluminio anodizzato preassemblato da murare senza falso telaio;

anodized aluminum frame to be installed without any subframe;

2 anta di spessore 55 mm in legno a struttura tamburata oppure in vetro e profilo in alluminio. Completa di serratura magnetica (3), cerniere a scomparsa regolabili sui tre assi (4) e guarnizioni di battuta antirumore (5).

swing wood door, or glass door with aluminum frame, 55 mm thickness.

Hardware included: magnetic lockset (3), concealed hinges (4), anti-noise gasket (5).

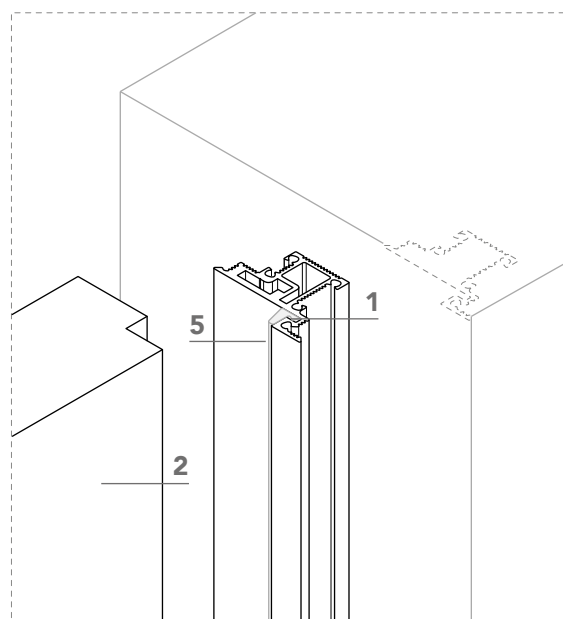
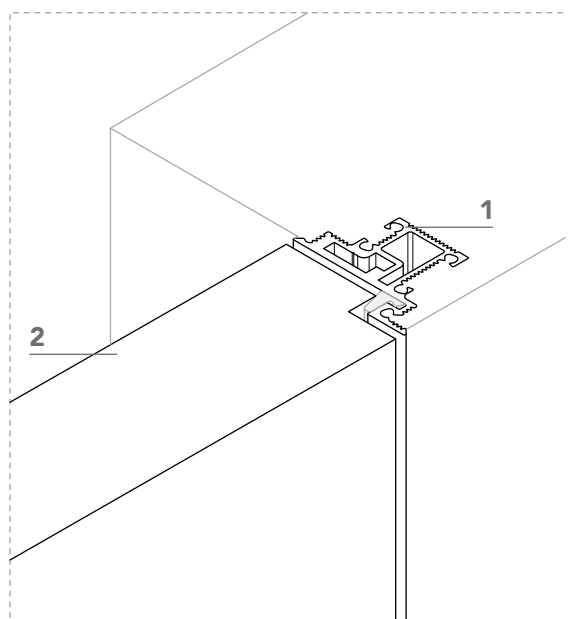

rasomuro 55s_

sezione verticale - vertical section

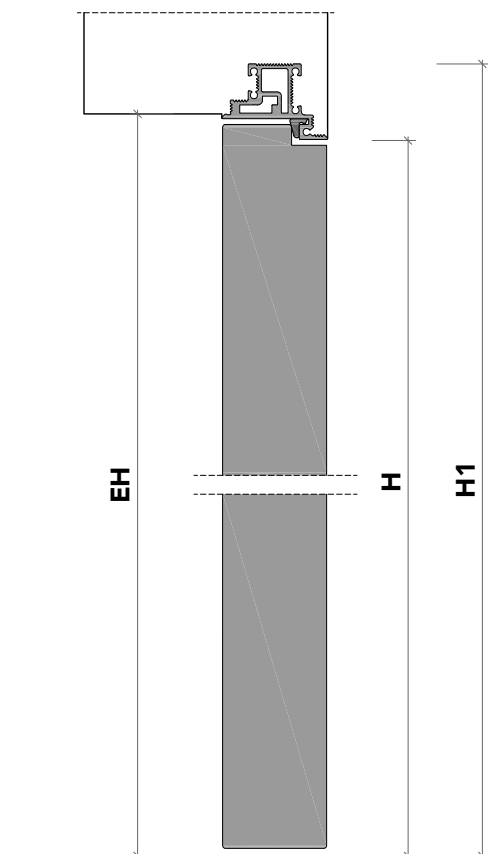

misure nette
net opening

L	=	luce / width
H	=	altezza / height

vano muro
rough opening

L1	=	L + 100 mm
H1	=	H + 50 mm

ingombro totale
overall sizes

EL	=	L + 28 mm
EH	=	H + 14 mm

sezione orizzontale - horizontal section

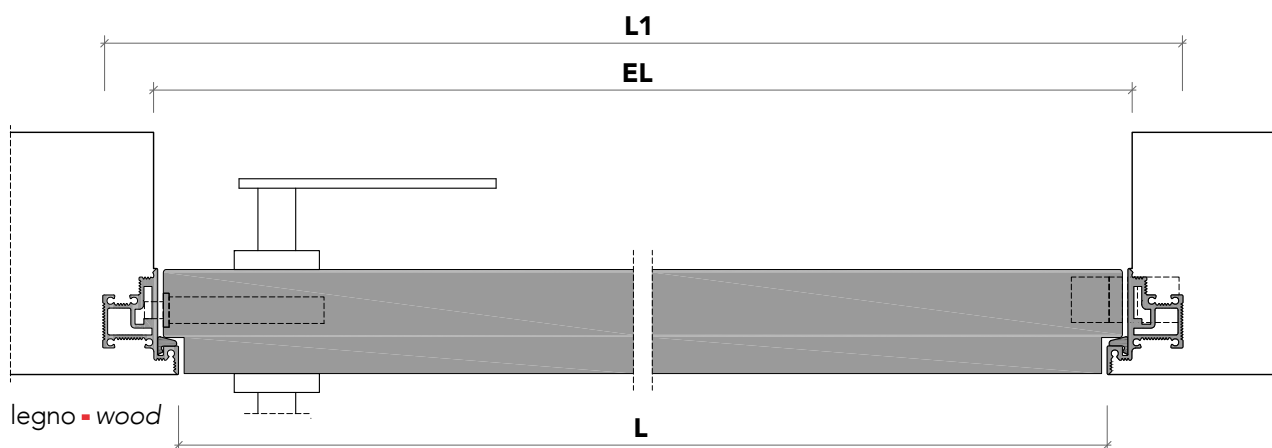

legno - wood

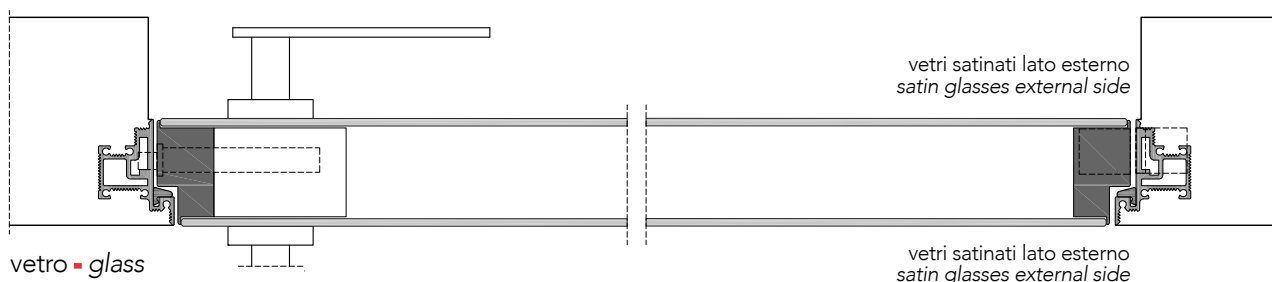

vetro - glass

vetri satinati lato esterno
satin glasses external side

vetri satinati lato esterno
satin glasses external side

rasomuro 55s_

telaio - frame

cartongesso - drywall

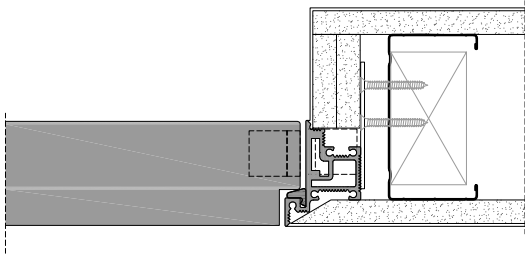

muratura - brickwall

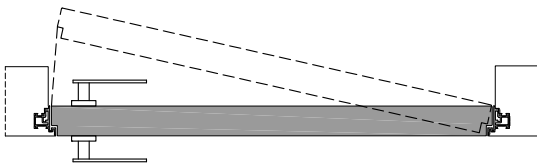
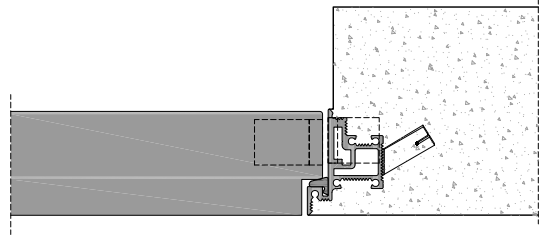

spingere destra - push right

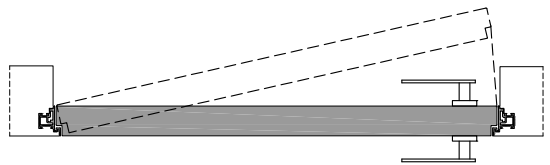
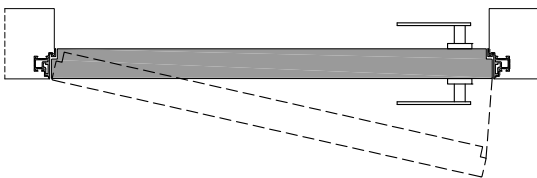

spingere sinistra - push left

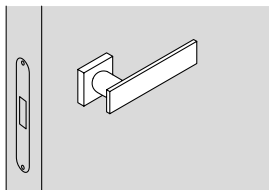
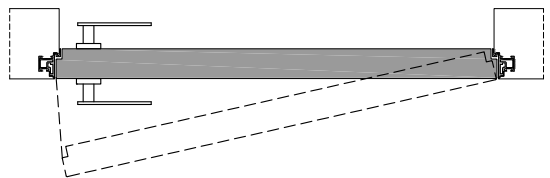

solo maniglia
only passage

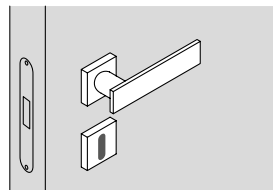

maniglia e chiave
handle and key

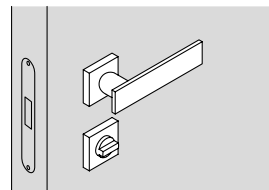

maniglia e nottolino
handle and privacy

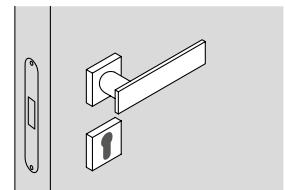

maniglia e cilindro di sicurezza
handle and security cylinder