

## Drive\_

Porta scorrevole esterno muro in legno con binario invisibile.  
*Sliding external wall wood door with invisible track.*

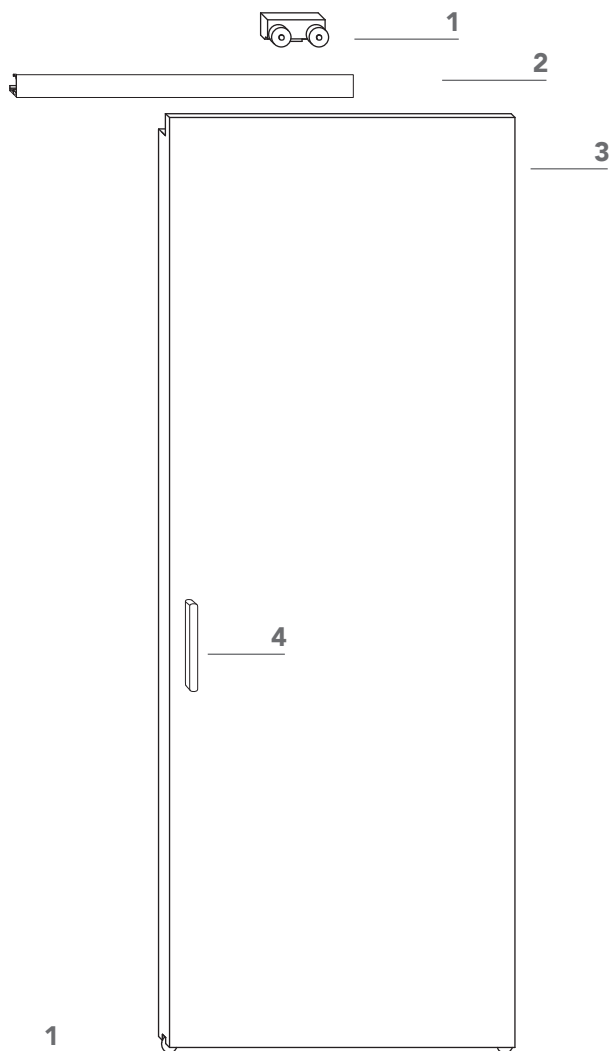

- 1** carrello a parete e rotelle di scorrimento a pavimento;  
*wall door trolley and floor sliding rollers;*
- 2** sistema di scorrimento integrato nel pannello dotato di freni deceleranti;  
*concealed sliding mechanism, with shock absorber;*
- 3** anta di spessore 41 mm in legno con struttura tamburata;  
*sliding wood door 41 mm thickness;*
- 4** maniglia senza serratura.  
*handle without lockset.*

## Finiture - Finishing

### Anta - Panel

*laccati opachi e lucidi - matte and glossy lacquer paint*

bianco gesso - bianco ottico - avorio - grigio calce - grigio tortora - grigio ferro - terra  
*chalk white - pure white - ivory - lime grey - dove grey - iron grey - clay*

*essenze - veneer*

rovere: naturale - moka - thermowood - nero fossile - grigio - oak: natural - moka - thermowood - black fossil - grey  
noce canaletto - canaletto walnut

# Drive\_

sezione verticale - vertical section

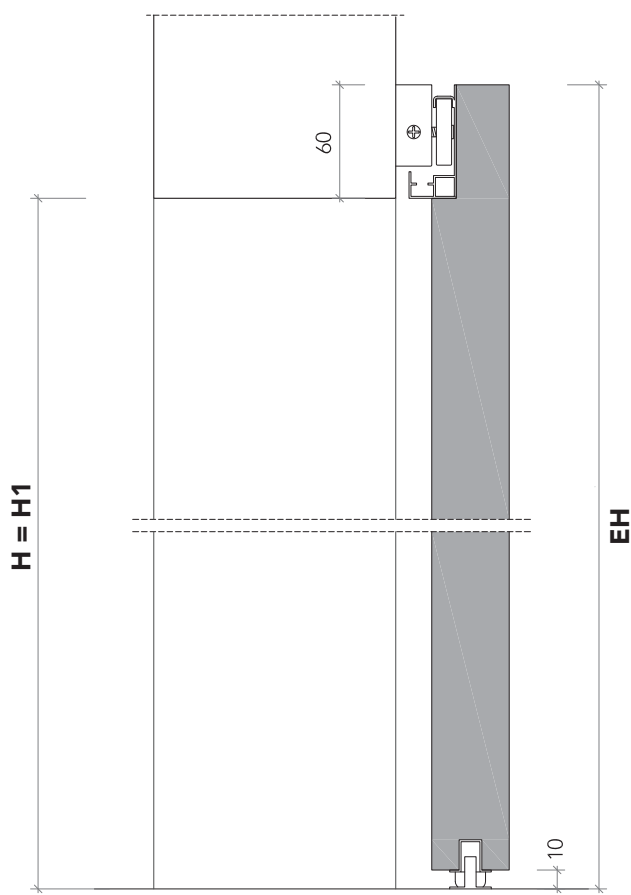

misure nette  
net opening

**L** = luce / width  
**H** = altezza / height

luce passaggio  
clear opening

**LP** =  $L - 80$  mm

vano muro  
rough opening

**L1** = L  
**H1** = H

ingombro totale  
overall sizes

**EL** =  $L + 110$  mm  
**EH** =  $H + 60$  mm

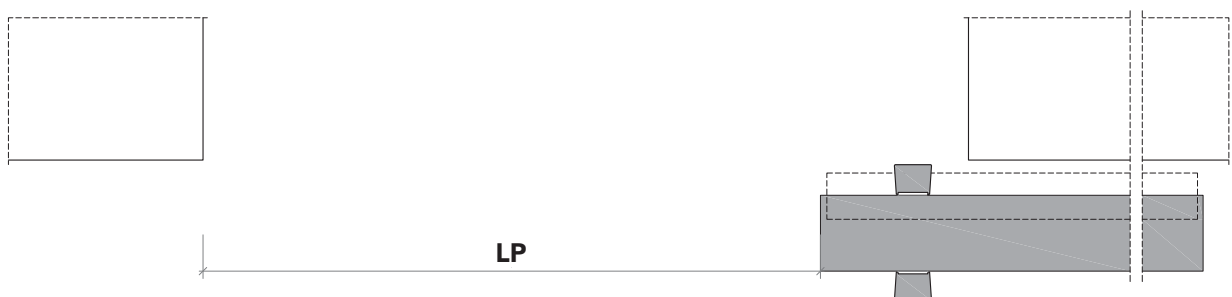
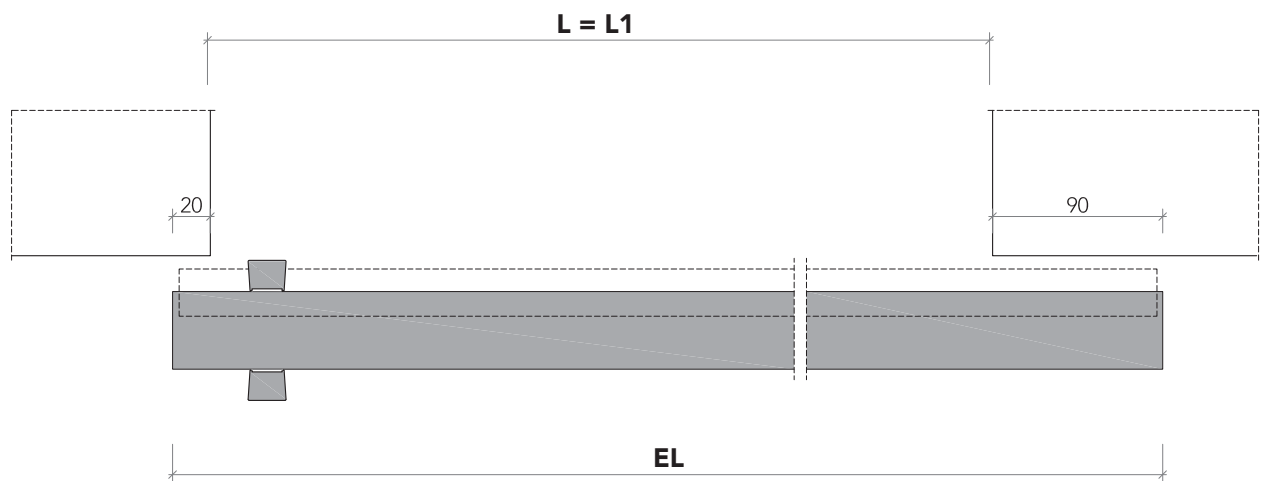

# Drive\_

cartongesso ▪ *drywall*

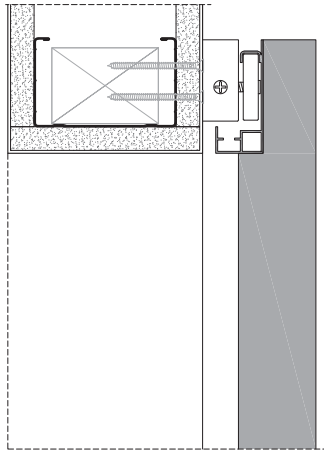

maniglia ▪ *handle*

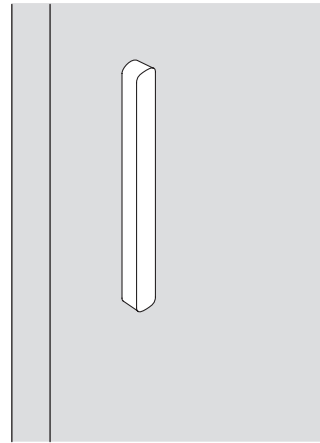

muratura ▪ *brickwall*

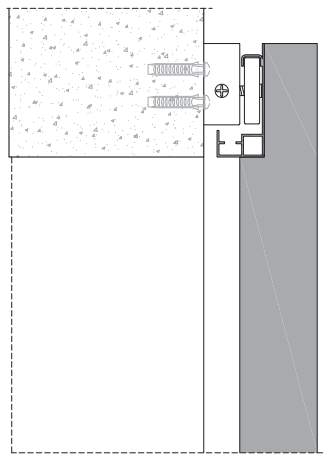

scorrevole destra ▪ *sliding right*

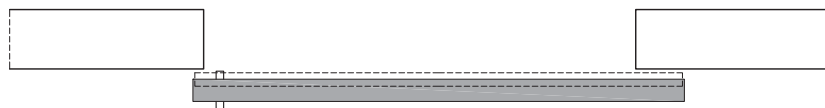

scorrevole sinistra ▪ *sliding left*



# Drive\_

Dettagli in scala 1:1.  
Drawing details.

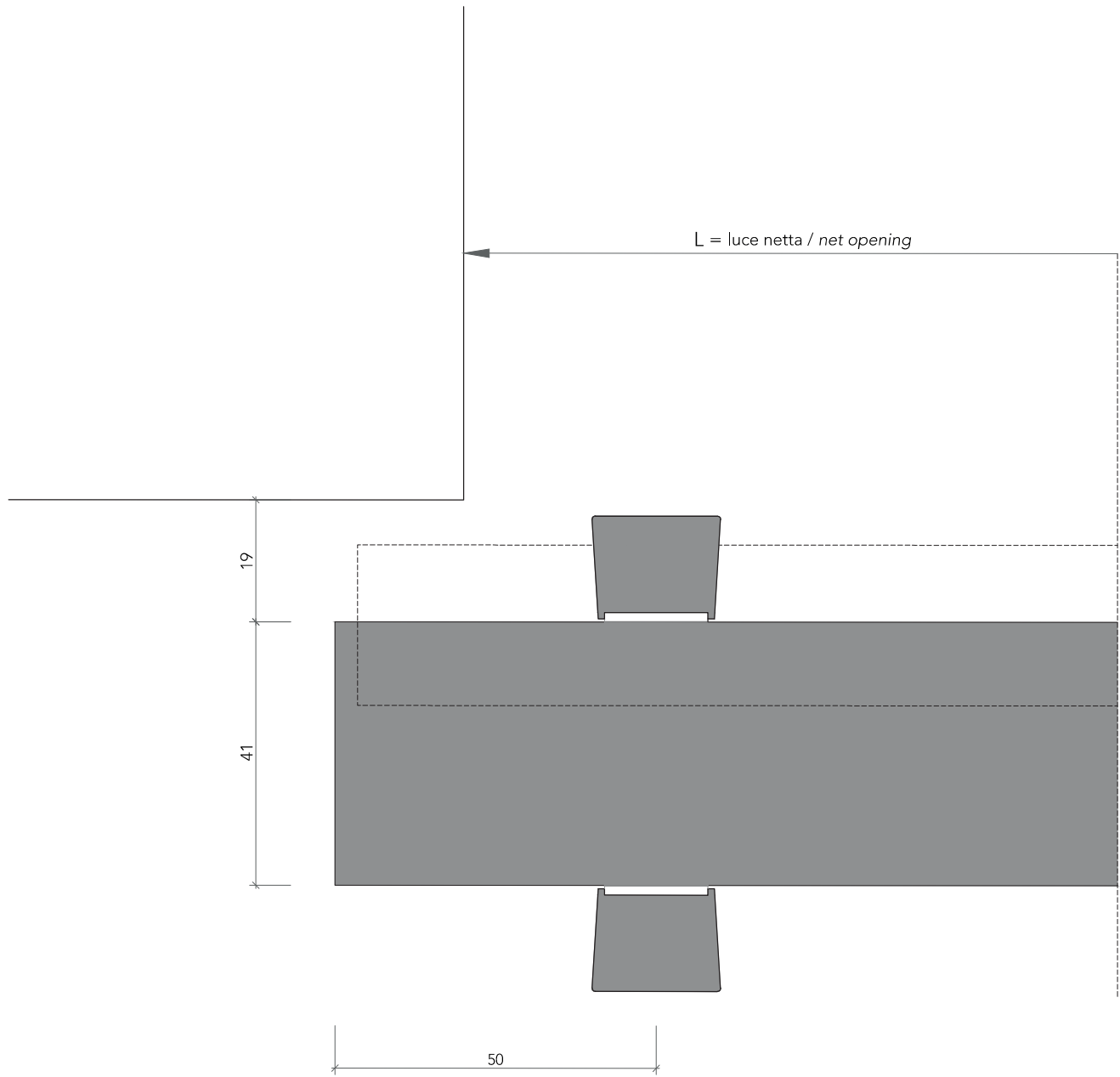

sezione orizzontale  
horizontal section

# Drive\_

Dettagli in scala 1:1.  
Drawing details.

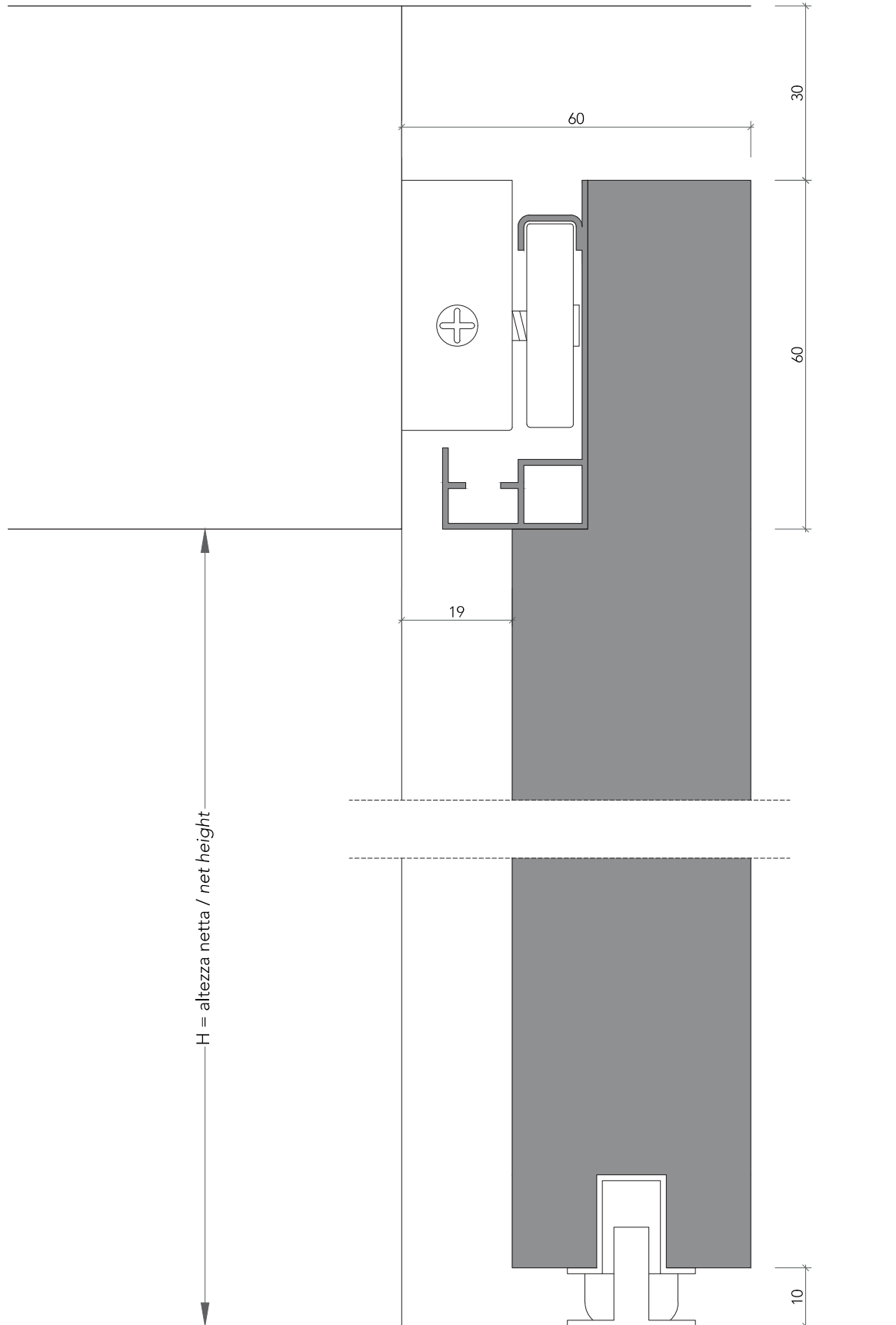

sezione verticale  
vertical section