

Teatro _versione ante libere - free panels version

Sistema di ante a bilico centrale.
Door pivoting central system.

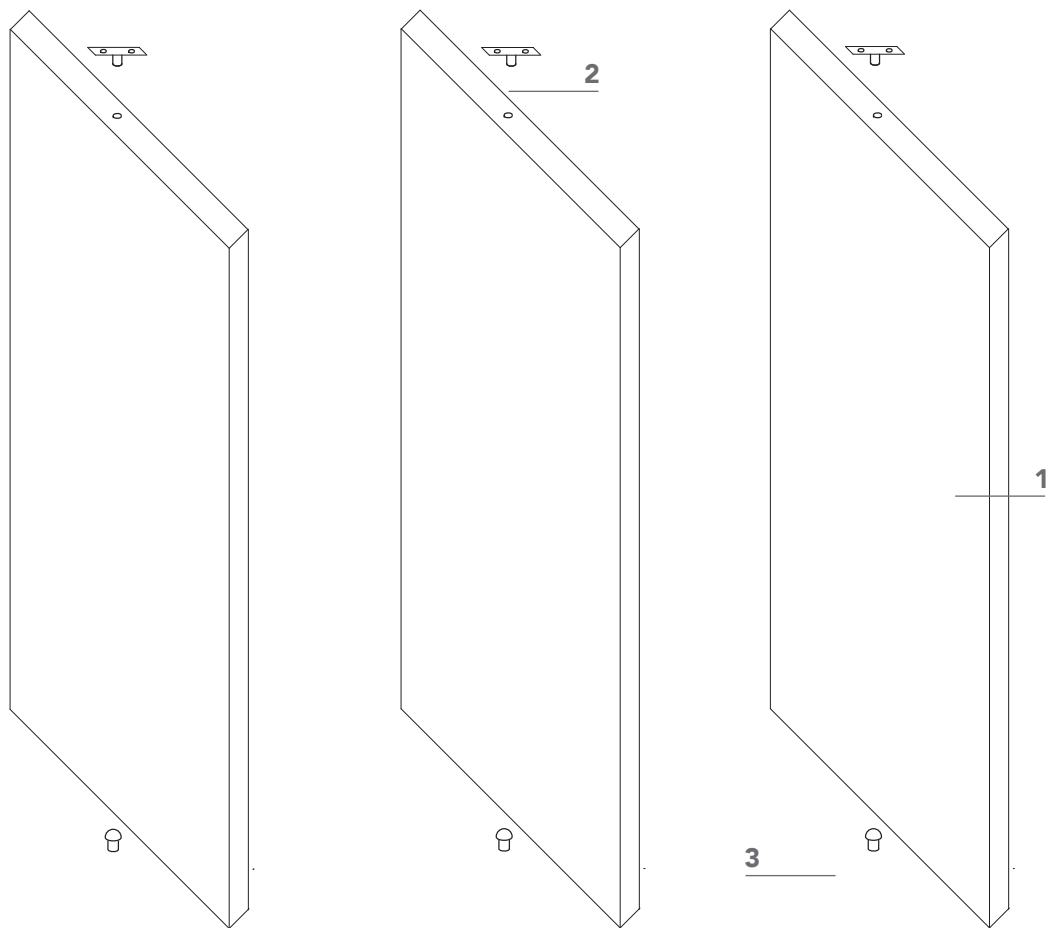

- 1** porta a bilico di spessore 55 mm, configurabile in diversi sistemi di pannelli pivotanti centrali. Completa di perni di fissaggio (2-3);

pivoting door with 55 mm thick. The system is with central pivoting panels. locking pins (2-3);

Finiture - Finishing

Anta - Panel

laccati opachi e lucidi - matte and glossy lacquer paint

bianco gesso - bianco ottico - avorio - grigio calce - grigio tortora - grigio ferro - terra
chalk white - pure white - ivory - lime grey - dove grey - iron grey - clay

essenze - veneer

rovere : naturale - moka - thermowood - nero fossile - grigio - oak: natural - moka - thermowood - black fossil - grey
noce canaletto - canaletto walnut

Matrix - Matrix design

specifiche Matrix - Matrix details

Teatro_ versione ante libere - free panels version

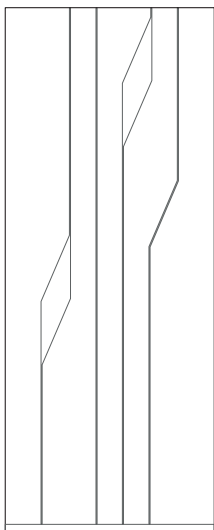

Decoro in metallo bronzato su entrambi i lati (disponibile solo per laccato opaco ed essenze)

Metal bronze decoration both sides (available only for matte lacquer paint and veneer)

Teatro _versione ante libere - free panels version

sistema a bilico pavimento / soffitto - pivoting system floor / ceiling

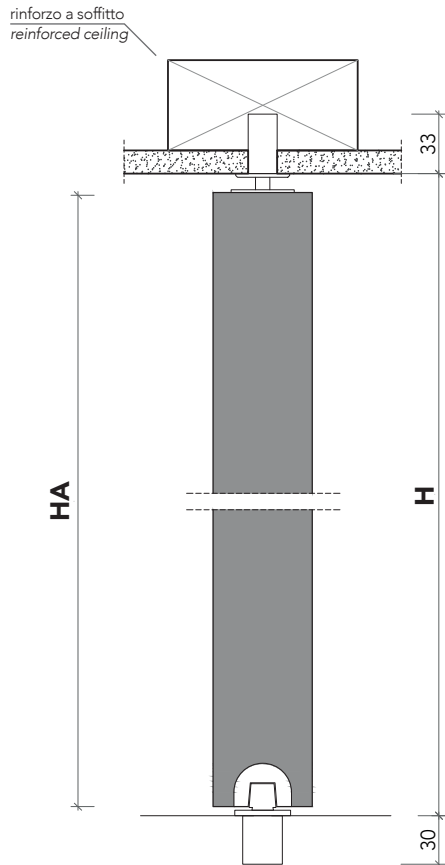

misure nette
net opening

L = luce / width
H = altezza / height

sistema a 2 ante
2 panel system
misure ante
panel sizes

LA = $(L - 15 \text{ mm}) / 2$
HA = $H - 20 \text{ mm}$

sistema a 3 ante
3 panel system
misure ante
panel sizes

LA = $(L - 20 \text{ mm}) / 3$
HA = $H - 20 \text{ mm}$

sistema a 4 ante
4 panel system
misure ante
panel sizes

LA = $(L - 25 \text{ mm}) / 4$
HA = $H - 20 \text{ mm}$

sistema a 5 ante
5 panel system
misure ante
panel sizes

LA = $(L - 30 \text{ mm}) / 5$
HA = $H - 20 \text{ mm}$

L2 = $LA / 2$

sezione orizzontale a 3 ante - horizontal section with 3 panel

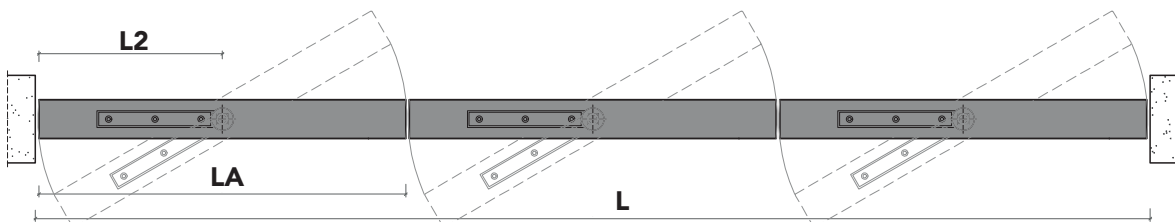

Teatro

configurazioni / configuration

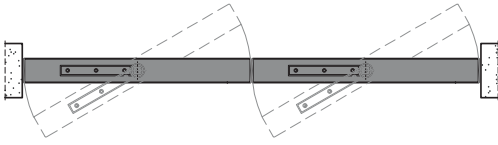

sistema a 2 ante - 2 panel system

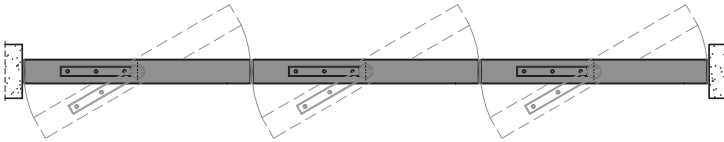

sistema a 3 ante - 3 panel system

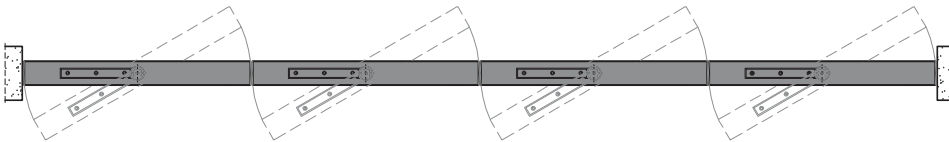

sistema a 4 ante - 4 panel system

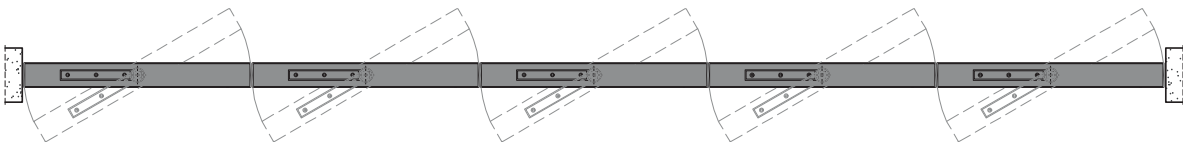

sistema a 5 ante - 5 panel system

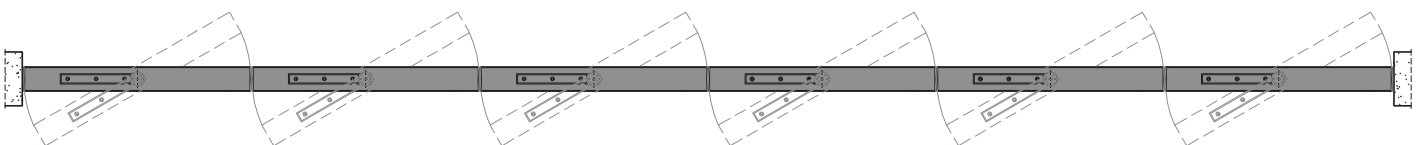

sistema a 6 ante - 6 panel system

Teatro_ versione sincronizzata - Synchronized version

Sistema di ante a bilico centrale.

Door pivoting central system.

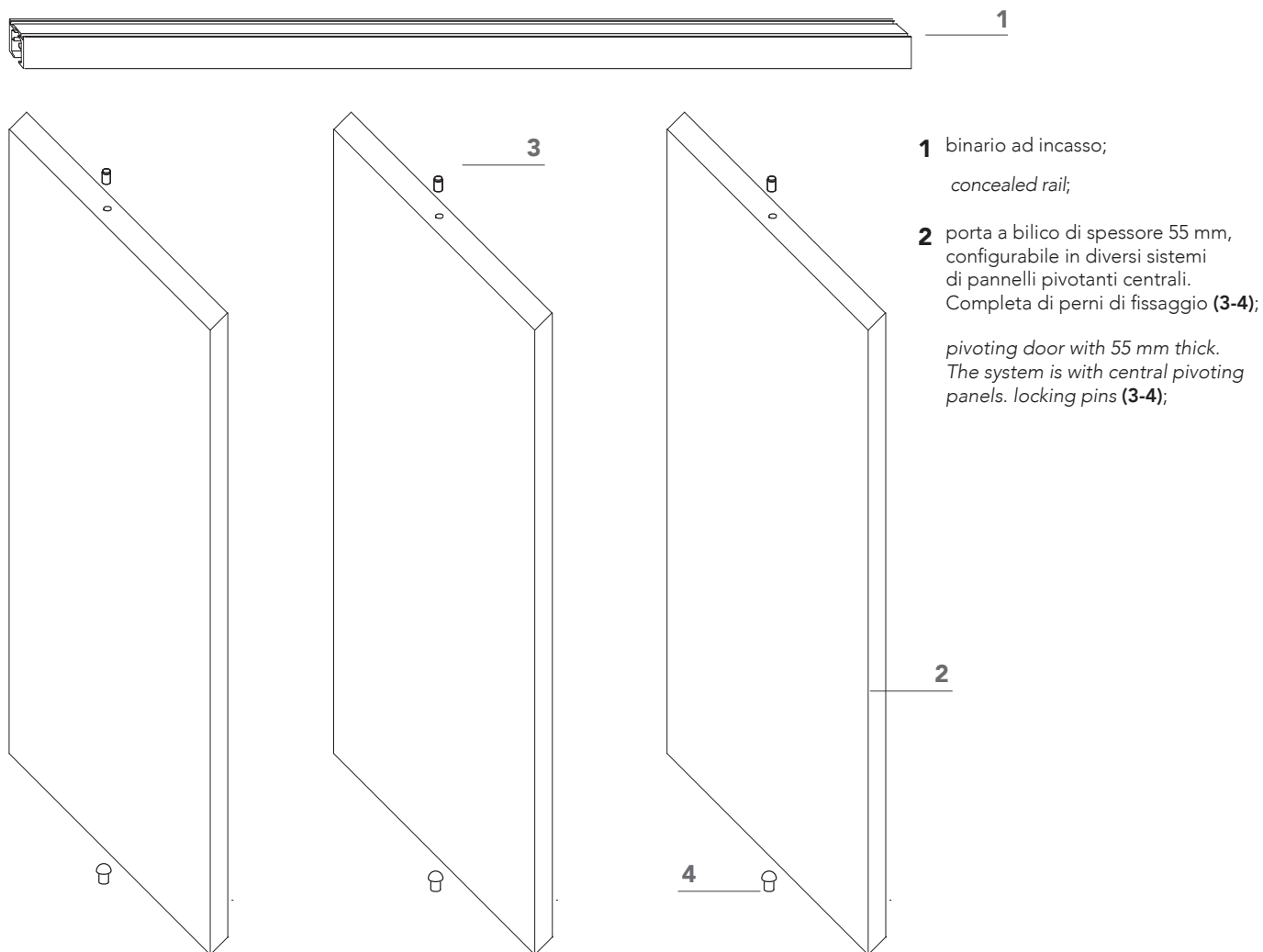

Finiture - Finishing

Binario - Rail

alluminio - aluminum

bianco opaco - matte white

Anta - Panel

laccati opachi e lucidi - matte and glossy lacquer paint

bianco gesso - bianco ottico - avorio - grigio calce - grigio tortora - grigio ferro - terra
chalk white - pure white - ivory - lime grey - dove grey - iron grey - clay

essenze - veneer

rovere : naturale - moka - thermowood - nero fossile - grigio - oak: natural - moka - thermowood - black fossil - grey
noce canaletto - canaletto walnut

Matrix - Matrix design

specifiche Matrix - Matrix details

Teatro_ versione sincronizzata - Synchronized version

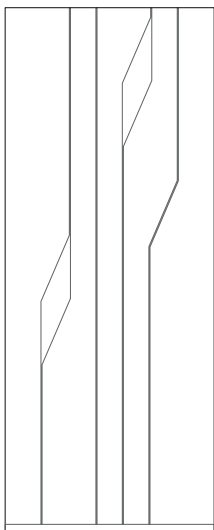

Decoro in metallo bronzato su entrambi i lati (disponibile solo per laccato opaco ed essenze)
Metal bronze decoration both sides (available only for matte lacquer paint and veneer)

Teatro_ versione sincronizzata - Synchronized version

binario ad incasso - concealed rail

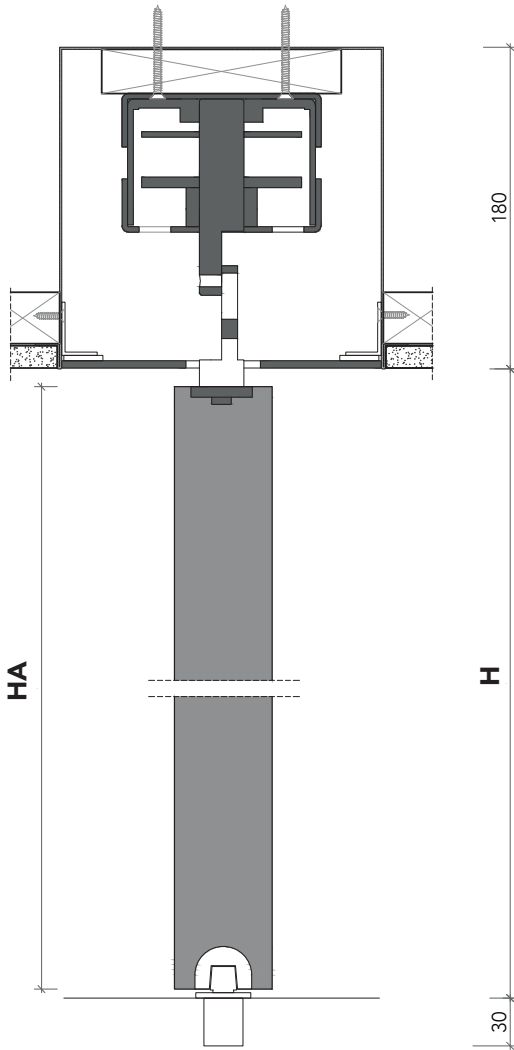

falso binario subframe

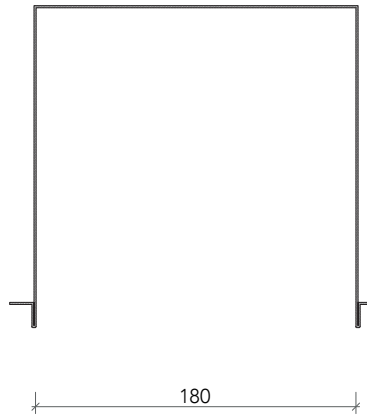

binario singolo single rail

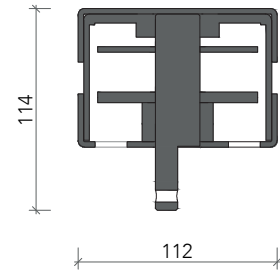

misure nette **L** = luce / width
 net opening **H** = altezza / height

sistema a 2 ante **LA** = $(L - 15 \text{ mm}) / 2$
 2 panel system **HA** = $H - 20 \text{ mm}$
 misure ante
 panel sizes

sistema a 3 ante **LA** = $(L - 20 \text{ mm}) / 3$
 3 panel system **HA** = $H - 20 \text{ mm}$
 misure ante
 panel sizes

sistema a 4 ante **LA** = $(L - 25 \text{ mm}) / 4$
 4 panel system **HA** = $H - 20 \text{ mm}$
 misure ante
 panel sizes

sistema a 5 ante **LA** = $(L - 30 \text{ mm}) / 5$
 5 panel system **HA** = $H - 20 \text{ mm}$
 misure ante
 panel sizes

$$L2 = LA / 2$$

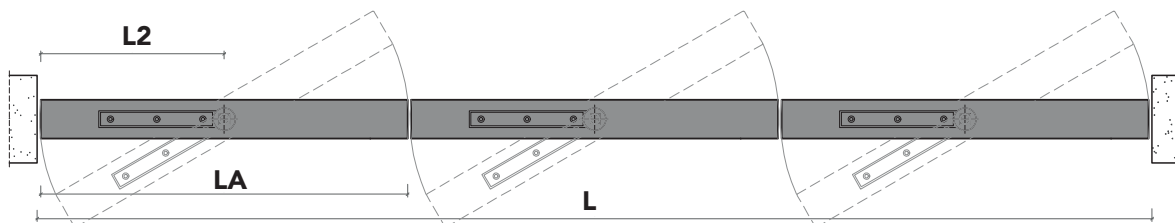

sezione orizzontale a 3 ante - horizontal section with 3 panel

Teatro_ versione sincronizzata motorizzata - Motorized synchronized version

binario ad incasso ■ concealed rail

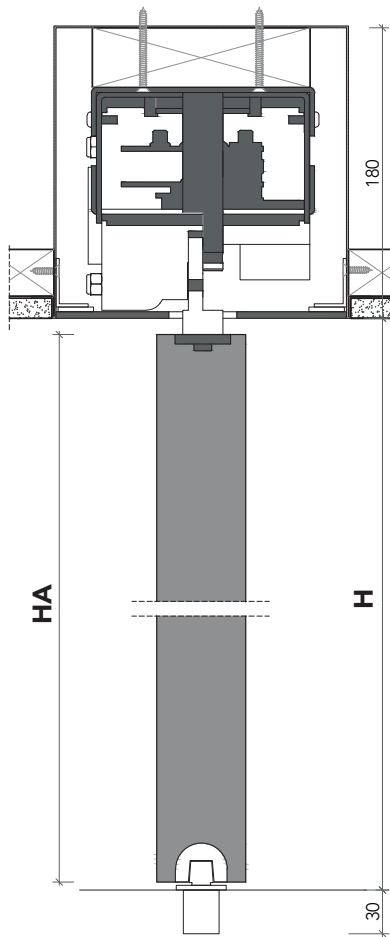

falso binario subframe

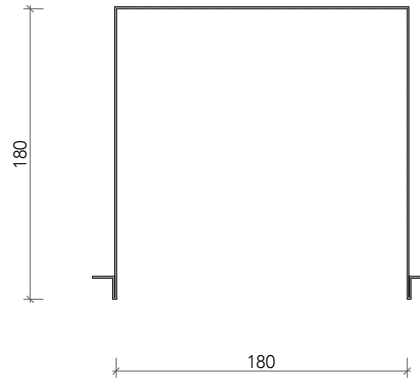

binario singolo single rail

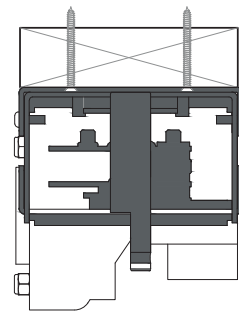

misure nette | **L** = luce / width
 net opening | **H** = altezza / height

sistema a 2 ante | **LA** = (L - 15 mm) / 2
 2 panel system | **HA** = H - 15 mm
 misure ante
 panel sizes

sistema a 3 ante | **LA** = (L - 20 mm) / 3
 3 panel system | **HA** = H - 15 mm
 misure ante
 panel sizes

sistema a 4 ante | **LA** = (L - 25 mm) / 4
 4 panel system | **HA** = H - 15 mm
 misure ante
 panel sizes

sistema a 5 ante | **LA** = (L - 30 mm) / 5
 5 panel system | **HA** = H - 15 mm
 misure ante
 panel sizes

$$\mathbf{L2} = \mathbf{LA} / 2$$

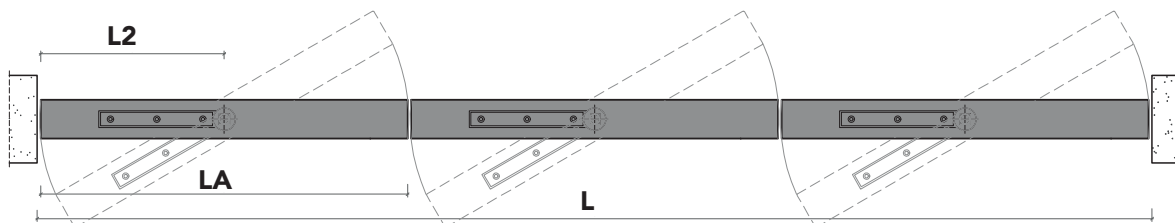

sezione orizzontale a 3 ante ■ horizontal section with 3 panel

Teatro_versione sincronizzata - Synchronized version

Dettagli in scala 1:1.

Drawing details.

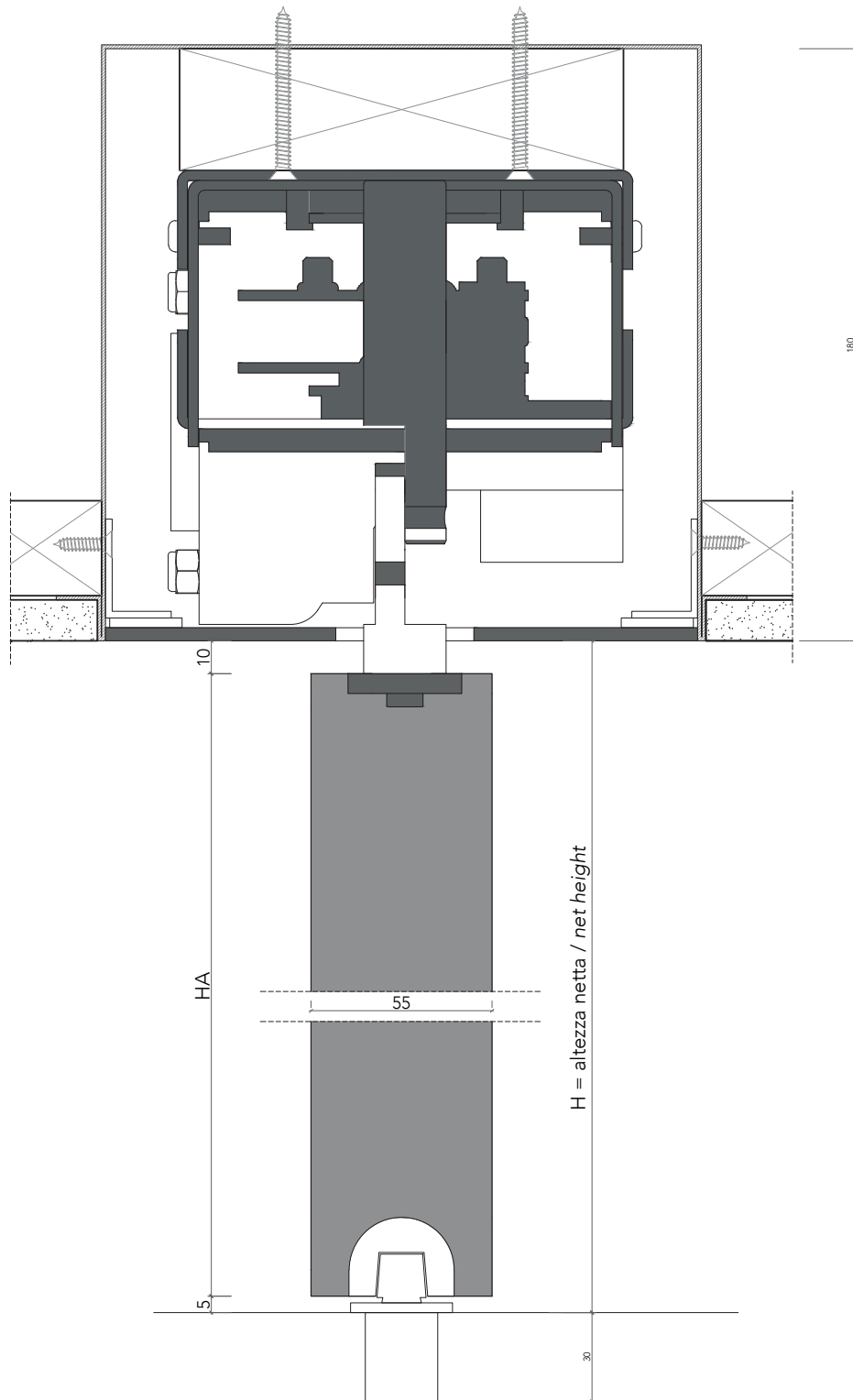

sezione verticale scala 1:2
vertical section

Teatro _versione sincronizzata motorizzata - Motorized synchronized version

Dettagli in scala 1:1.

Drawing details.

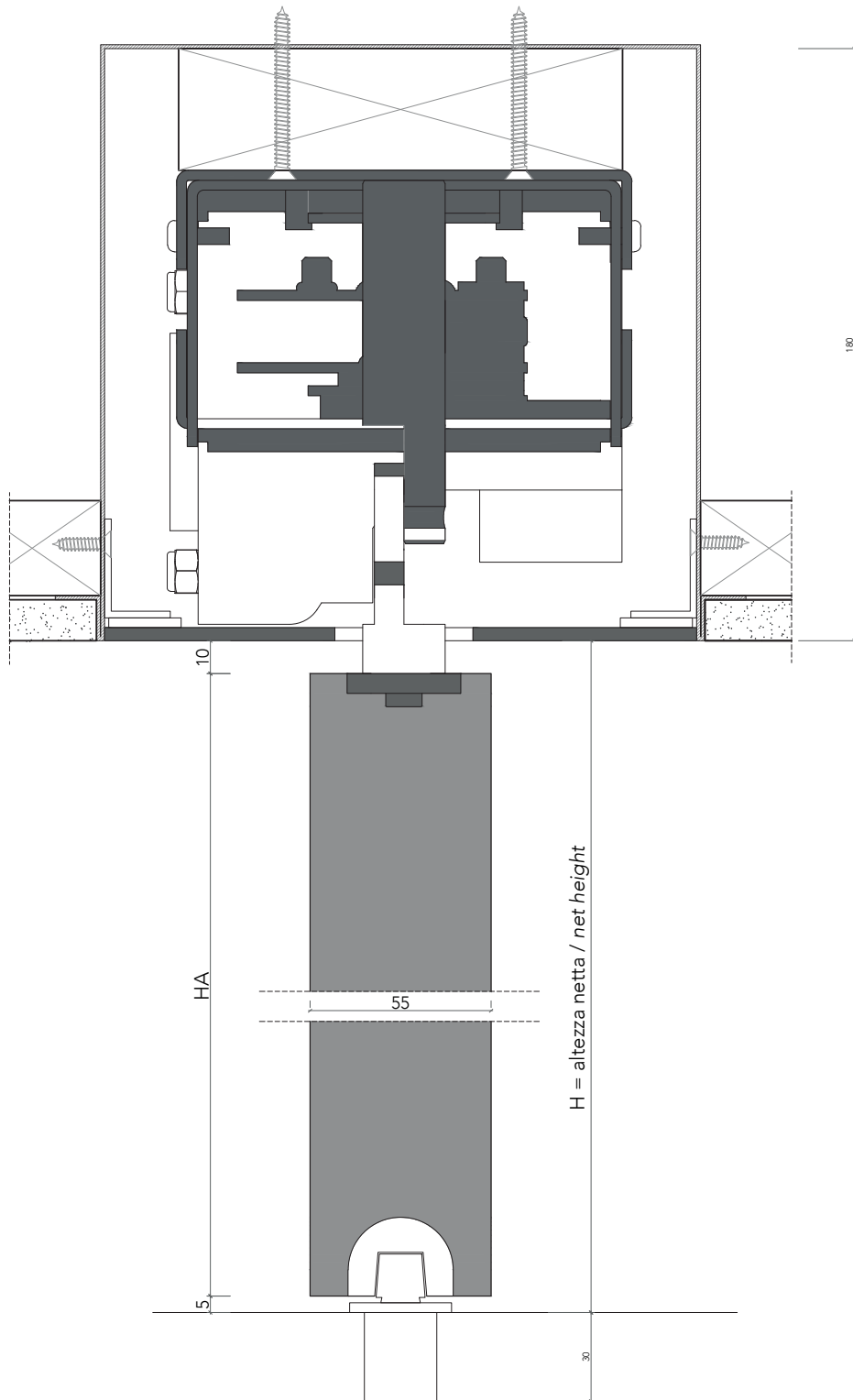

sezione verticale scala 1:2
vertical section