

Filo 55s_ Porta a battente in legno complanare sul lato a spingere - *Swing wood door flush with push side*

Filo 55t_ Porta a battente in legno complanare sul lato a tirare - *Swing wood door flush with pull side*

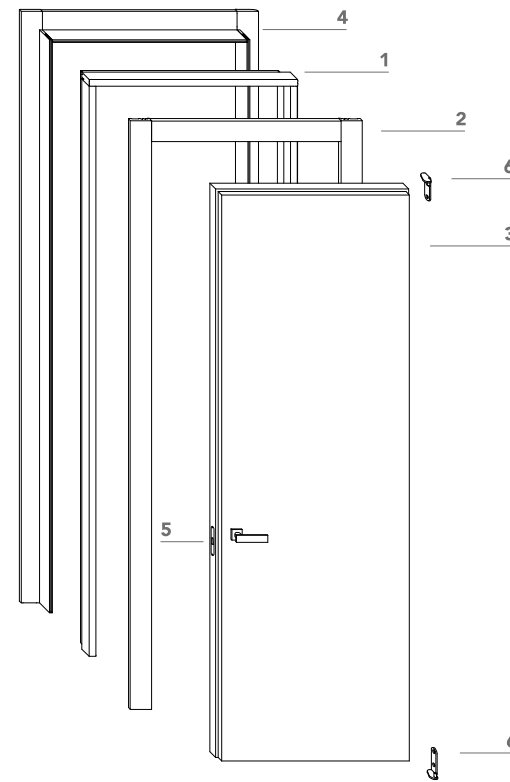

1 stipite portante in legno;
wood jamb;

2 coprifilo piatto di spessore 12 mm
complanare con l'anta lato spingere
(filo S), oppure complanare lato a tirare
(filo T);

*trim 12 mm thickness: flush with the
door on the push side (filo S), or flush
with the door on the pull side (filo T);*

3 anta di spessore 55 mm in legno con
struttura tamburata. Completa di
serratura magnetica (5), cerniere a
scoparsa (6) e guarnizione di battuta
antirumore (7);

*swing wood door 55 mm thickness.
Hardware included: magnetic lockset (5),
concealed hinges (6), anti-noise gasket (7);*

4 coprifilo telescopico in legno di serie
per misure da 105 mm a 130 mm.
Spessore parete massimo 500 mm.

*telescopic wood trim for wall thickness
from 105 to 130 mm. Available for max wall
thickness 500 mm.*

Filo 55s_

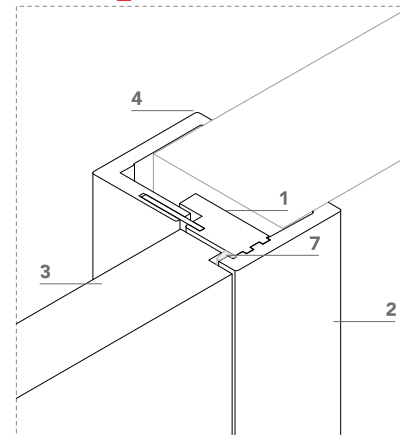

Filo 55t_

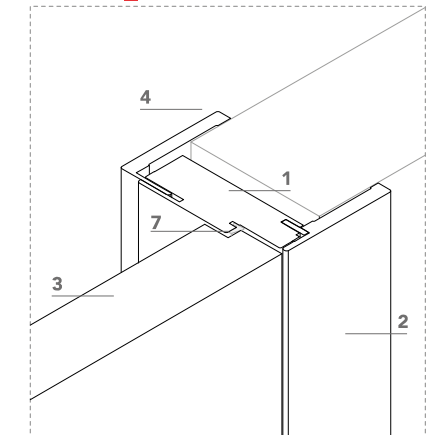

Filo 55s_

sezione verticale = vertical section

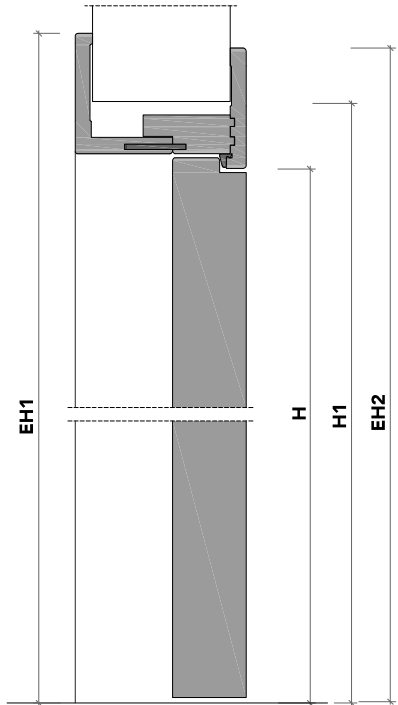

misure nette
net opening

L = luce / width
H = altezza / height

vano muro
rough opening

L1 = L + 100 mm
H1 = H + 50 mm

ingombro totale
overall sizes

EL1 = L + 203 mm
EH1 = H + 101 mm
EL2 = L + 181 mm
EH2 = H + 90 mm

sezione orizzontale = horizontal section

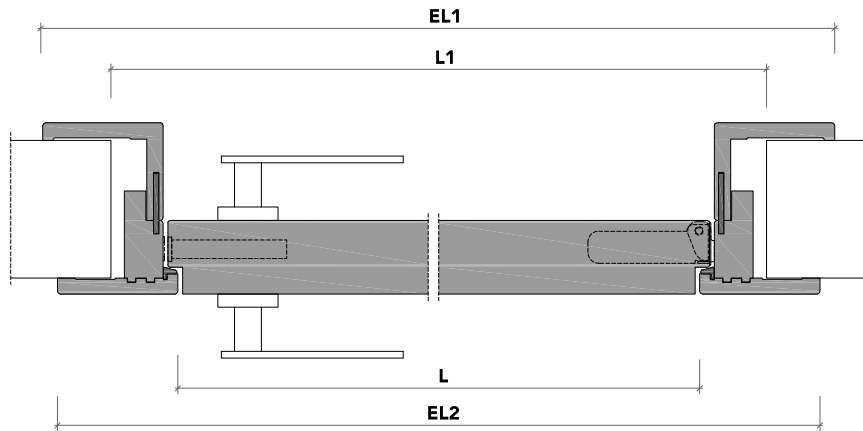

lualdi

Filo 55s_

stipite telescopico = telescopic jamb

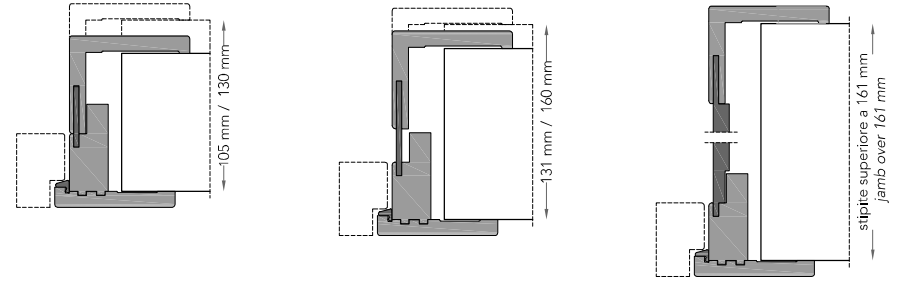

cartongesso = drywall

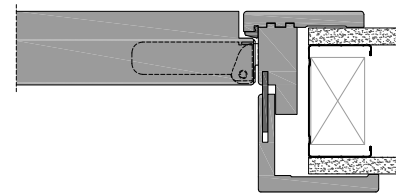

muratura = brickwall

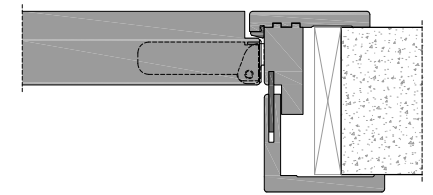

spingere destra = push right

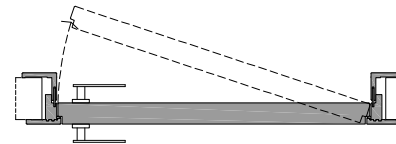

spingere sinistra = push left

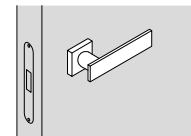
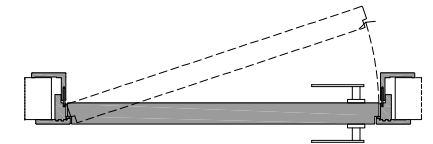

solo maniglia
only passage

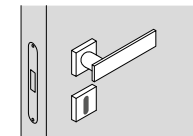

maniglia e chiave
handle and key

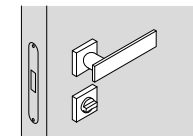

maniglia e nottolino
handle and privacy

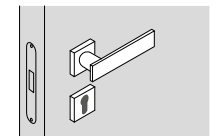

maniglia e cilindro di sicurezza
handle and security cylinder

lualdi

Filo 55 t_

sezione verticale = vertical section

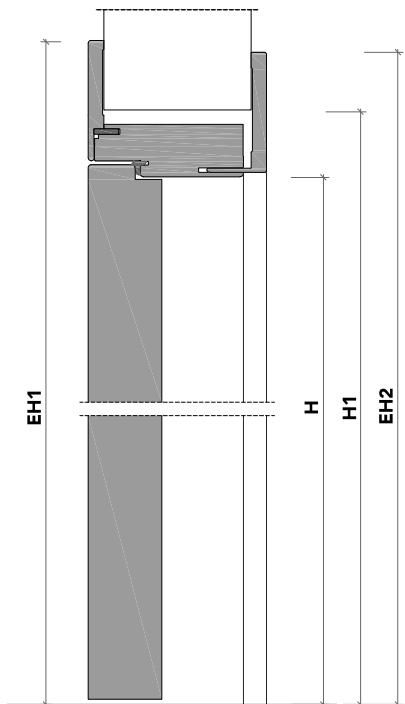

misure nette
net opening

L = luce / width
H = altezza / height

vano muro
rough opening

L1 = L + 100 mm
H1 = H + 50 mm

ingombro totale
overall sizes

EL1 = L + 203 mm
EH1 = H + 102 mm
EL2 = L + 185 mm
EH2 = H + 93 mm

sezione orizzontale = horizontal section

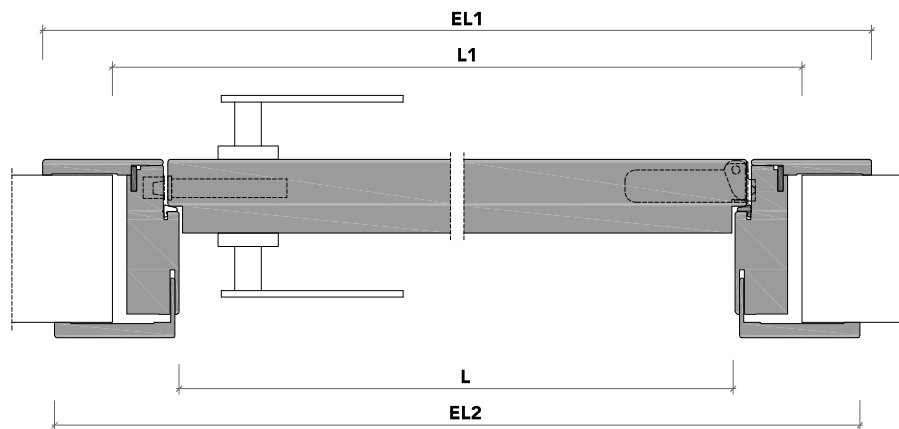

lualdi

Filo 55 t_

stipite telescopico = telescopic jamb

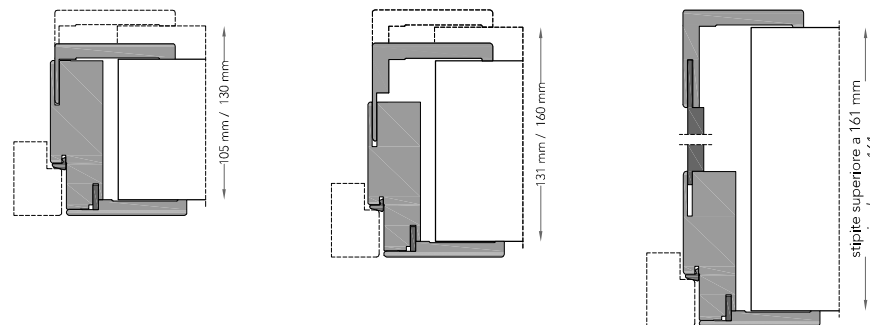

cartongesso = drywall

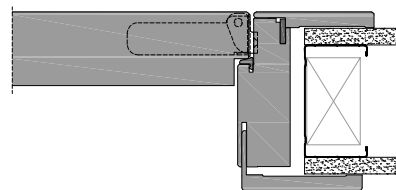

muratura = brickwall

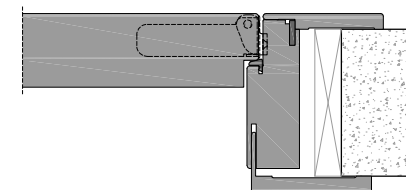

spingere destra = push right

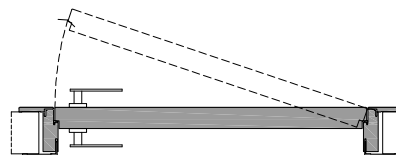

spingere sinistra = push left

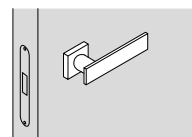
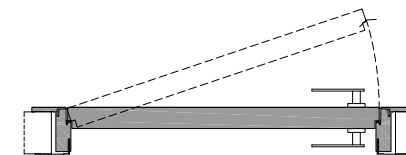

solo maniglia
only passage

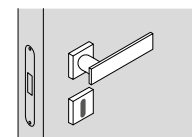

maniglia e chiave
handle and key

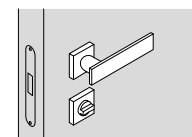

maniglia e nottolino
handle and privacy

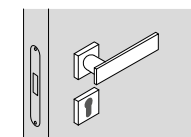

maniglia e cilindro di sicurezza
handle and security cylinder

lualdi