

Koan plus_

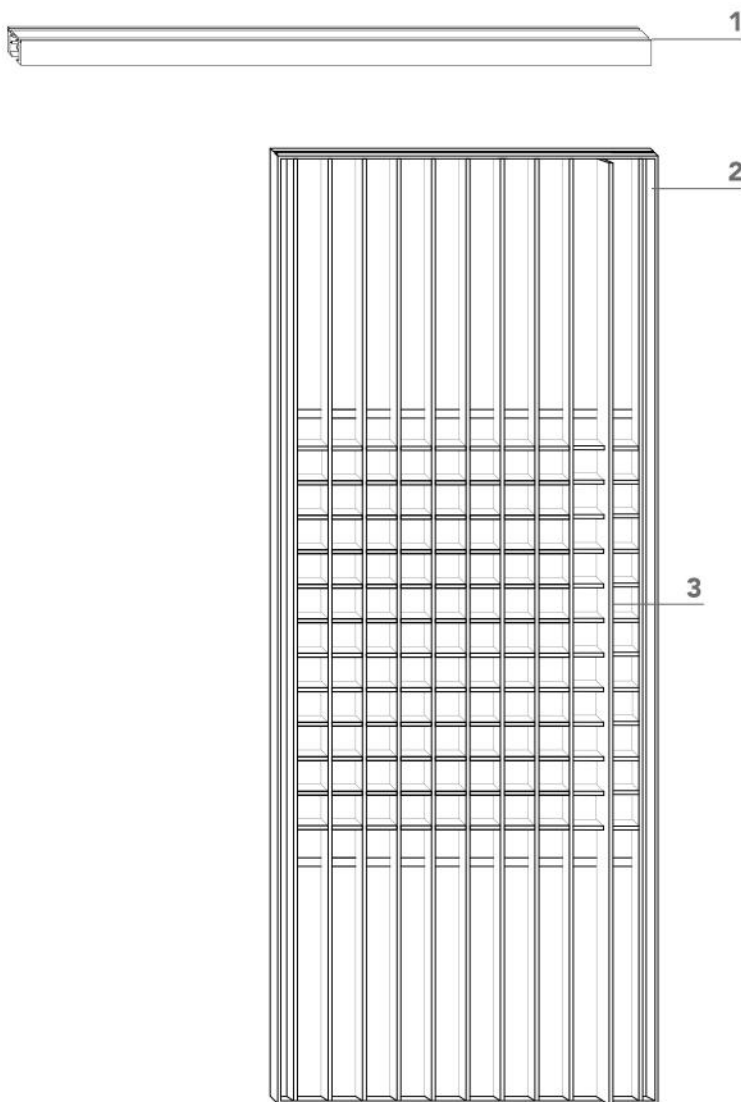

1 binario con sistema decelerante e carrello con meccanismo di regolazione in altezza;

rail with shock absorber system and trolley with height adjustment mechanism;

2 anta di spessore 50 mm, configurabile in diversi sistemi di pannelli scorrevoli e fissi, disponibile con vetro di sicurezza spessore 6 mm, profilo in alluminio e listelli;

sliding system with aluminum frame 50 mm thick, tempered glass 6 mm thick and slats. The system is available with fix and sliding panels;

3 maniglia inclusa.
handle included.

Finiture - Finishing

Binario e profilo anta - Rail and panel profile

alluminio - aluminum

naturale - nero opaco - bianco opaco - bronzo - brill spazzolato - natural - matte black - matte white - bronze - brushed brill

Listelli - Slats

essenze - veneer

rovere : naturale - moka - oak: natural - moka

noce canaletto - canaletto walnut

Anta in vetro - Glass panel

vetri base - standard glass

trasparente: extrachiaro - grigio - bronzo - transparent: extraclear - grey - bronze

satinato (un lato) : extrachiaro - grigio - bronzo - satin (one side): extraclear - grey - bronze

vetri riflettenti - reflective glass

riflettente (un lato) : extrachiaro - grigio - bronzo - reflective (one side): extraclear - grey - bronze

Koan_
binario singolo / single rail

binario ad incasso - recessed rail

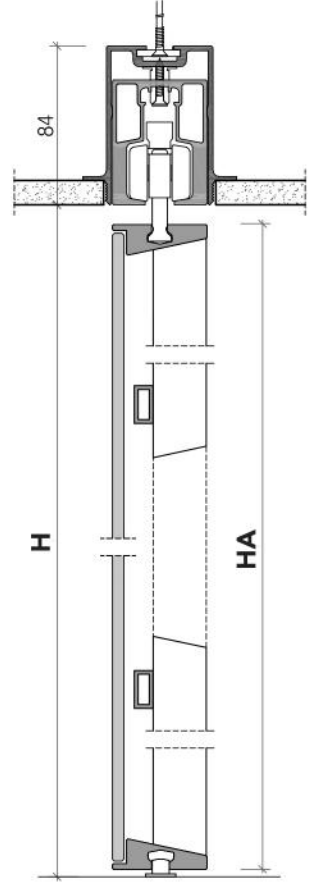

binario esterno - external rail

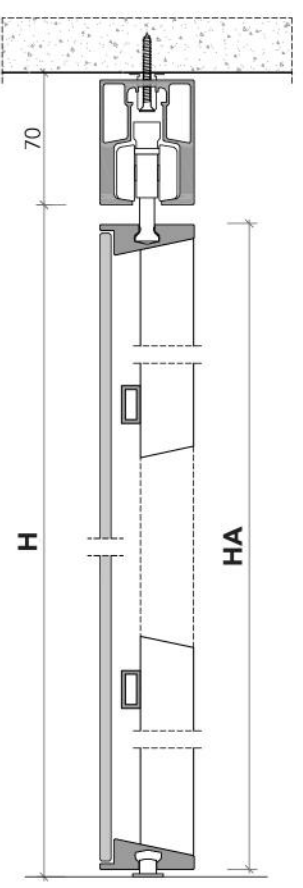

binario a parete - wall rail

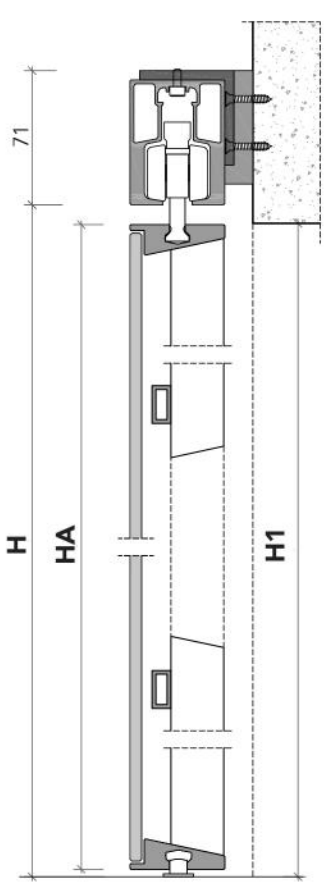

misure nette / net opening
L = luce / width
H = altezza / height

misura anta / panel sizes
LA = L + 14 mm
HA = H - 14 mm

H1 = H - 10 mm

Koan_
binario doppio / double rail

binario ad incasso - recessed rail

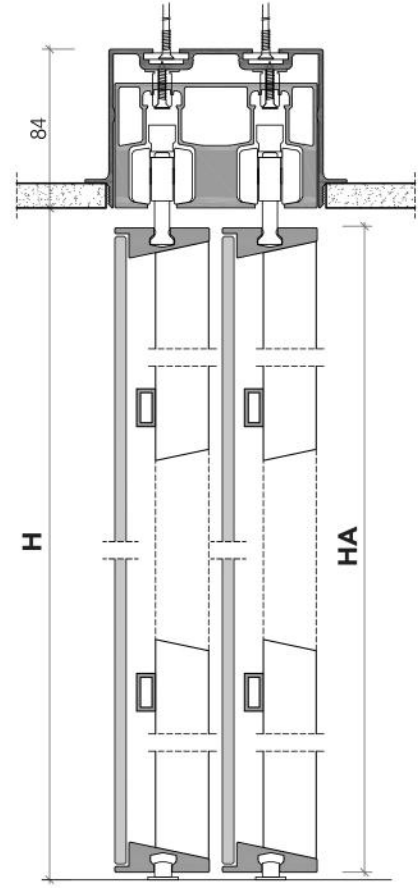

binario esterno - external rail

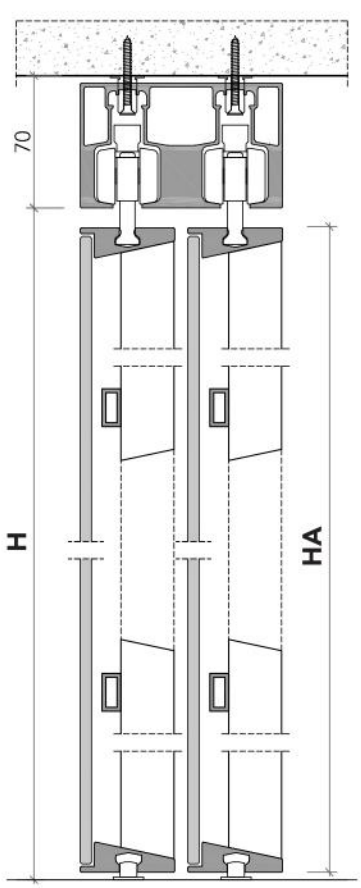

misure nette / net opening
L = luce / width
H = altezza / height

misura anta / panel sizes
LA = (L + 7 mm) / 2
HA = H - 14 mm

falso binario / subframe

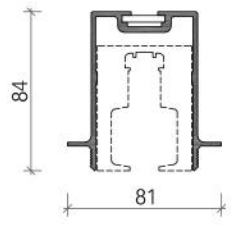

binario singolo / single rail

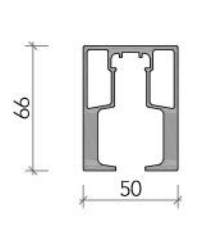

supporto a parete / wall fastening

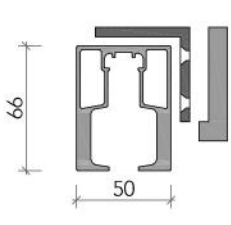

falso binario / subframe

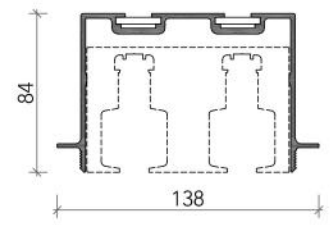

binario doppio / double rail

